

### EARLIER VERSIONS:

This kit fits **all** earlier versions of the model 2088. Do not be alarmed if this kit appears physically different than your existing upper housing/switch assembly.

**NOTE:** Before starting work, make certain that power to pump is off. Release liquid pressure on the outlet line of pump before performing maintenance. You may find it easier to remove the pump and work on a bench.

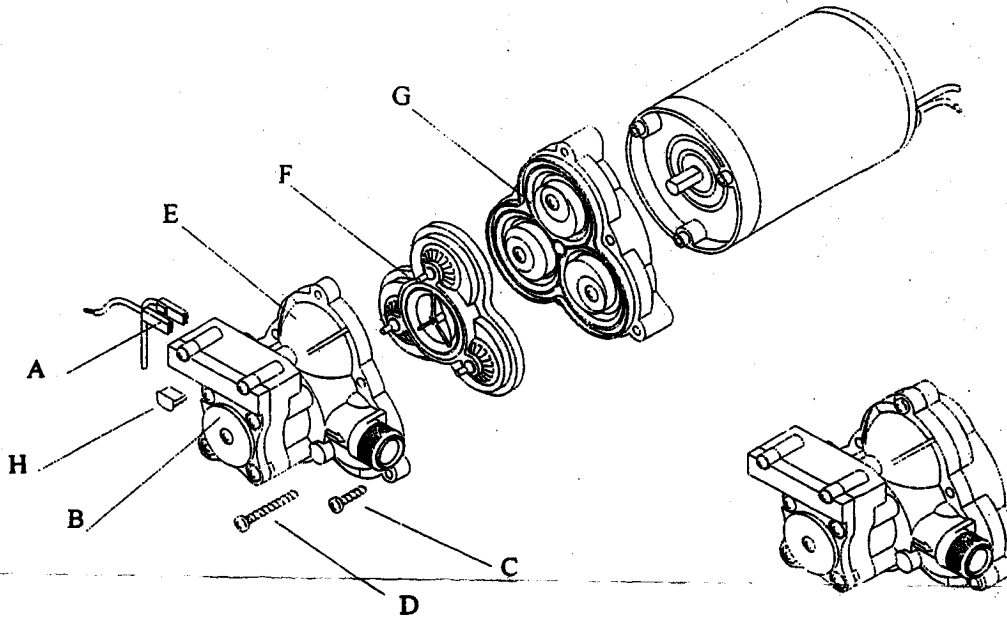

### DISASSEMBLY:

1. Remove the three upper housing screws (C). Note: Do not remove the pressure switch screws.
2. Remove the three long screws (D). These screws hold the pump assembly to the motor. Note: If you work carefully, the lower housing will not separate from the motor assembly.
3. Remove the upper housing (E).
4. Remove the old valve assembly (F) from the upper housing.

### ASSEMBLY:

1. Locate the new valve assembly (F) flush with the diaphragm (G) (Align groove in diaphragm with groove in valve assembly).
2. Place the upper housing (E) on top of the valve assembly (F).
3. Tighten the three outer screws (C).
4. Put the three long screws (D) in place and screw down until each touches, then tighten each screw securely.



**SHURflo** ★  
5900 Katella Ave.  
Cypress, CA 90630  
(800) 854-3218 (562) 795-5200  
FAX (562) 795-7564  
Shipping/UPS: 5900 Katella Ave.  
Bldg. B  
Cypress, CA 90630

# SHURflo

First in Fluid Innovation

SHURflo reserves the right to update specifications, prices, or make substitutions.

**SHURflo East**  
52748 Park Six Court  
Elkhart, IN 46514-5427  
(800) 762-8094  
(574) 262-0478  
FAX (574) 264-2169  
© 2001 Printed in USA

**SHURflo Ltd.**  
Unit 5 Sterling Park  
Gatwick Road, Crawley  
West Sussex, RH10 2QT  
United Kingdom  
+44 1293 424000  
FAX +44 1293 421880